



Electro-hydraulic two post lifts.

Possibility of installation in symmetrical or asymmetric version.

Self-alignment with automatic positioning.

Standard height of two-post connection: 4,050 mm

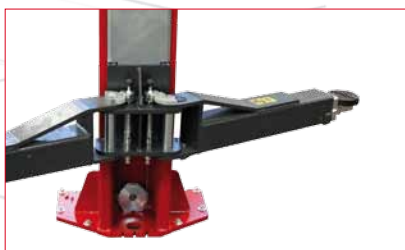

*Toothed sector arm rotation
stop system*

Available versions (with optional column extension set):

V: Specific for vans (Height of two-post connection: 4,620 mm)

XV: Specific for vans and very high vehicles, extra-above version (Height of two-post connection: 5,220 mm).

All models supplied with:

- ✓ Realignment of the two carriages using metal cables that guarantee excellent synchronisation.
- ✓ Anticrushing safety bar as standard.
- ✓ Two set of extension pads.

TECHNICAL DATA

| | |
|---------------------|---------------------------------|
| Lift capacity | 5500 kg |
| Lifting time | 45 s |
| Three phase motor | 400/230V - 3kW 3Ph - 50/60Hz |
| Single phase motor | 230V - 3kW 1Ph - 50/60Hz |
| Max. lifting height | 2080 mm |
| Lift minimum height | 100 mm |
| Height connection | 4050 / 4620 / 5220 mm |



Electro magnet safety release 24V

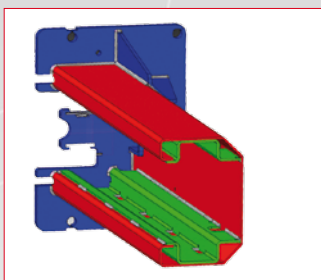

Internally reinforced column structure

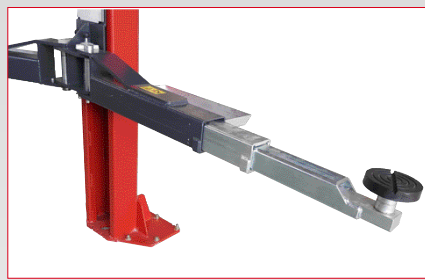

4 three-section symmetric arms

DIMENSIONS

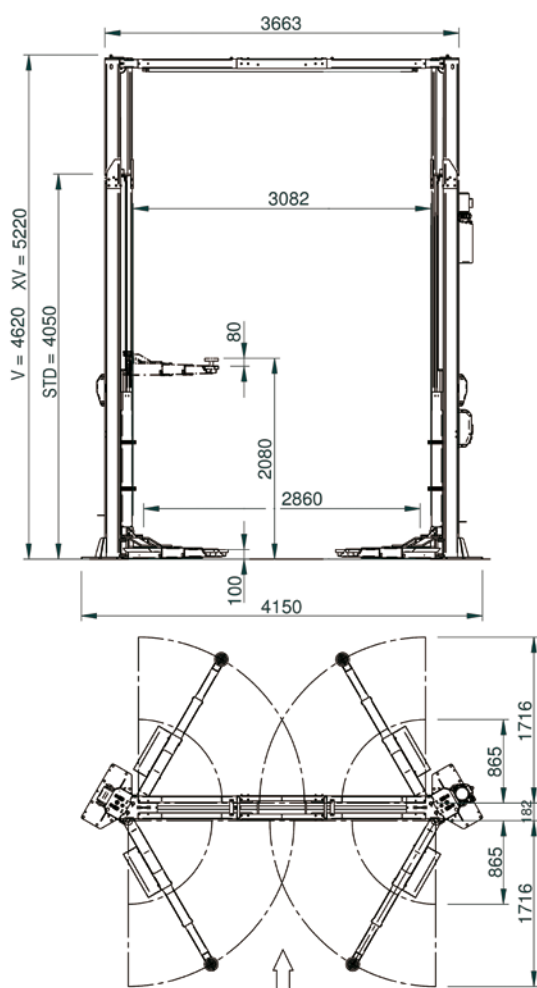

RECOMMENDED ACCESSORIES

- Set of masonry bolts (compulsory)
- 570 mm column extension set
- Emergency hand pump
- 1170 mm column extension set

